



## INSTRUCTION BULLETIN

No. 340029  
Machine: 800/810  
Published: 4-97/00  
System: SWEEPING

**NOTE: DO NOT DISCARD the Parts List from the Instruction Bulletin. Place the Parts List in the appropriate place in your machine manual for future reference. Retaining the Parts List will make it easier to reorder individual parts and will save you the cost of ordering an entire kit.**

*NOTE: Numbers in parenthesis ( ) are reference numbers for parts listed in Bill of Materials.*

Installation Instructions for Filter replacement kit number 375529

### **SYNOPSIS / PROBLEM:**

This kit contains the parts needed to replace the hopper dust filters on the machines listed above. The dust filters in this kit are designed for fine dust applications. Please follow step-by-step instructions.

### **SPECIAL TOOLS / CONSIDERATIONS:**

Gasket scraper, mineral spirits, isopropyl alcohol, propane torch.  
(Estimated Time to complete: 1 hour)

### **PREPARATION:**

1. Make sure the filters have been shaken and the hopper dumped before starting this procedure.

### **TO REMOVE THE OLD SEAL:**

(Refer to FIG. 1)

**FOR SAFETY: Before leaving or servicing machine, stop on level surface and set parking brake. Then turn off machine and remove key.**

1. Raise the hopper cover.
2. Un-plug both filter shaker motors from the hopper harness.
3. Remove the four M10 hex screws holding each filter shaker assembly to the hopper. Remove the filter shaker assemblies from the hopper. (Refer to Fig. 1)
4. Loosen the four M10 hex screws holding each filter retaining ring to the shaker panels. Rotate the filter retaining rings and remove them from the shaker panels. (Refer to Fig. 1)
5. Remove the filters from the shaker panels. (Refer to Fig. 1)
6. Inspect existing shaker panel seals and replace if necessary. Also, replace the seals if not the same as the latest version that is furnished with this kit.

7. Remove the old seals from the shaker panels using a gasket scraper.

*NOTE: Take care to avoid nicking or gouging the seal surface.*

8. Remove the old adhesive from the shaker panels using mineral spirits or a propane torch to soften the adhesive.

*NOTE: If using a propane torch, remove the four rubber isolators located at the corners of both shaker panels. Heat the old adhesive just enough to soften, and avoid charring the painted surfaces. Reinstall the isolators when all of the adhesive has been removed.*

9. Use the isopropyl alcohol to remove any residue of cleaning solvents, oils, etc.

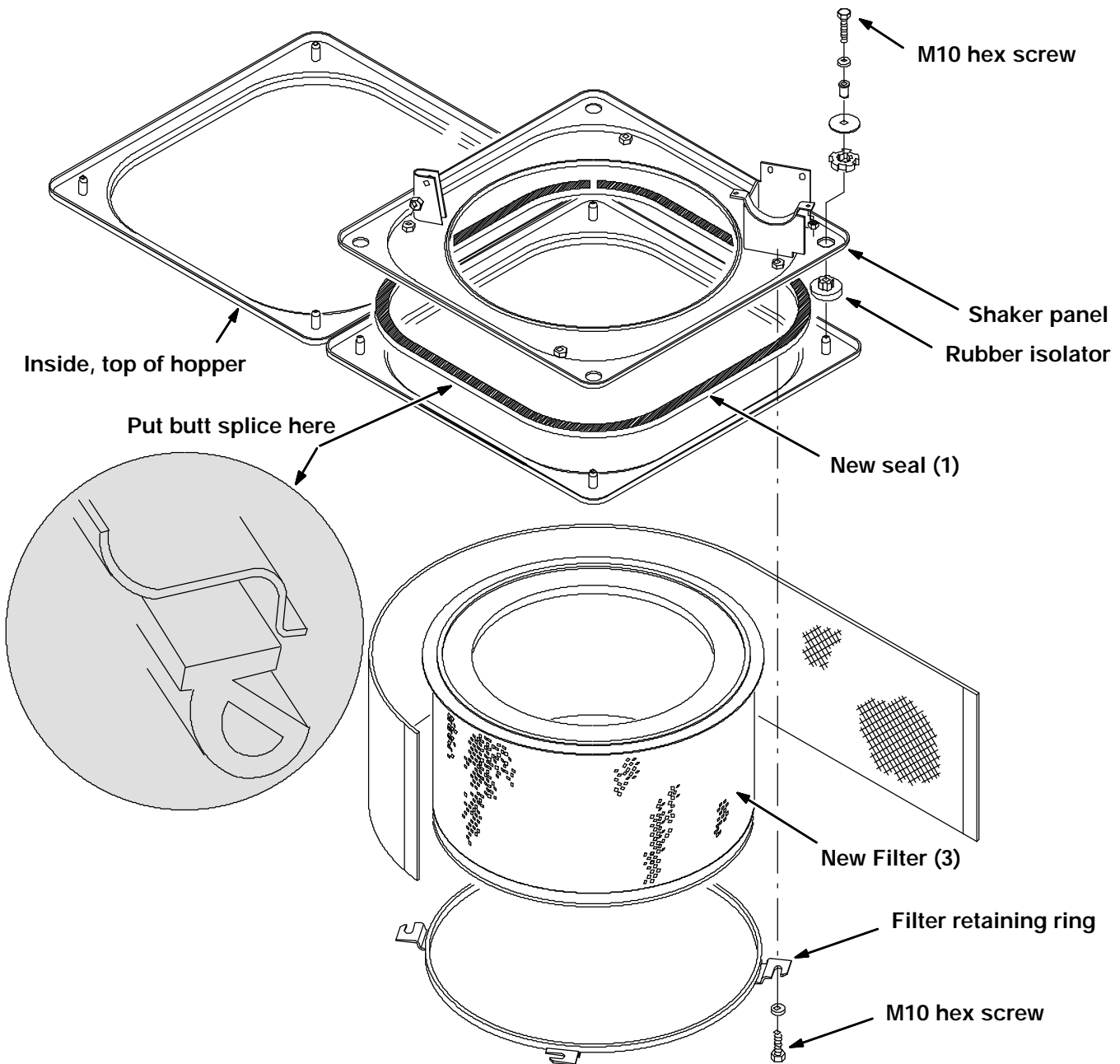

**FIG. 1 - Filter Shaker Assembly And Seal**

## TO INSTALL THE NEW SEAL:

(Refer to FIG. 1 and 2)

1. Peel the backing paper back approximately six inches at a time. This will prevent the seal from picking up any dirt or becoming tangled. Leave the last six inches until step #5.
2. Apply the new seal (1) to the shaker panel. **DO NOT STRETCH THE MATERIAL.** Be sure to make the butt splice in the center of the straight area of the shaker panel, not the corners. (Refer to Fig. 1 and 2)
3. Seal the butt splice with the contact adhesive 3M #1357 (2) or something equal. (Refer to Fig. 1 and 2)

*NOTE: Before butting the ends together, cut the seal so it is approximately 1/8 inch longer than the opposite end to allow some compression at the joint.*

4. Apply contact adhesive to both ends of the seal and allow to cure for about ten minutes before joining. (Refer to Fig. 2)
5. Butt the seal together, remove the remaining backing paper, press the seal into place. (Refer to Fig. 2)

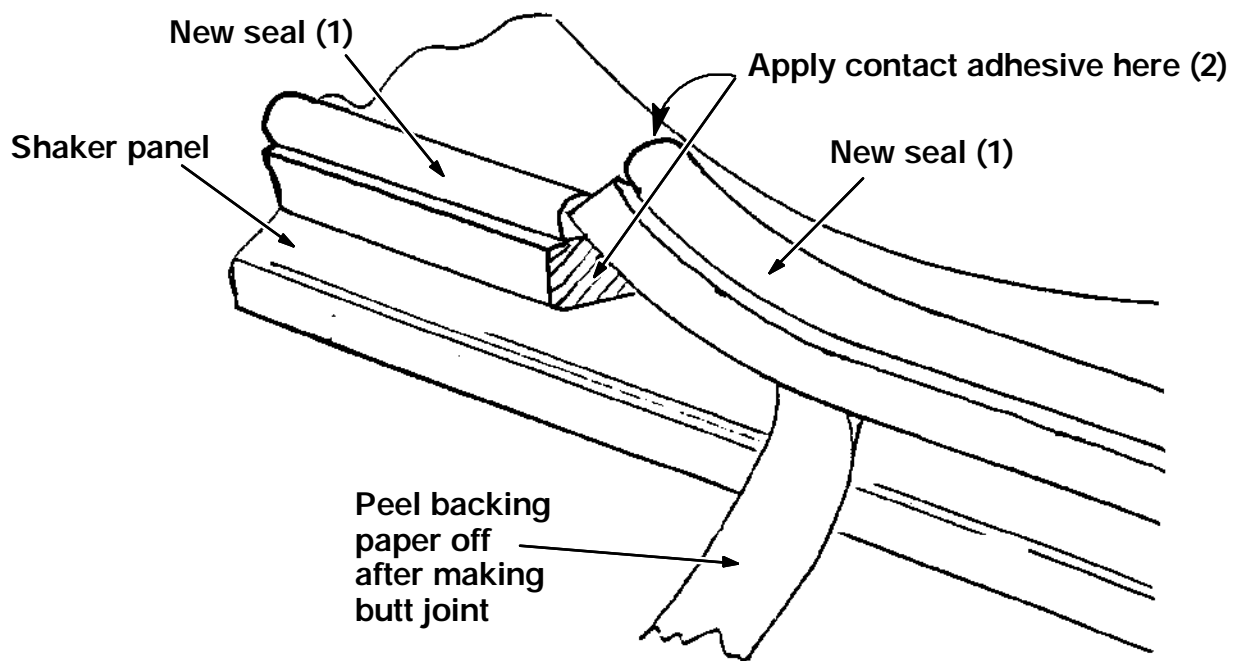

**FIG. 2 - Gluing Butt Splice**

6. Position the new filters (3) into the shaker panels. (Refer to Fig. 1)

*NOTE: Make sure the filter retaining rings are properly seated inside the mounting flange and not pinching or riding up on the flange edge.*

7. Tighten the four M10 filter retaining ring hex screws to 18 - 24 Nm (15 - 20 ft lb). (Refer to Fig. 1)
8. Reinstall the filter and shaker assemblies in the hopper. Tighten the four M10 filter assembly hex screws to 18 - 24 Nm (15 - 20 ft lb). (Refer to Fig. 1)
9. Plug the filter shaker motors back into the hopper harness. Close the hopper cover.

## TO CHECK FOR SHAKER SEAL LEAKS:

1. Clean the underside of the hopper cover and the entire filter shaker area thoroughly. Close the hopper cover.
2. Sweep in a dusty area for a period of time long enough to cause a need for filter shaking several times.
3. Open the hopper cover and check for any signs of dust migration to the *clean side* of the filters. Repair any leaks as necessary.

## BILL OF MATERIALS FOR SEAL REPLACEMENT KIT 375529

Ref.	TENNANT Part No.	Description	Qty.
1	23935	Seal, urethane	2
2	47037	Adhesive, contact #1357, 5oz.	1
3	48069	Filter, fine media	2

TENNANT COMPANY  
P. O. Box 1452  
Minneapolis, MN 55440-1452